



STAINLESS STEEL STANDARD CENTRIFUGAL PUMP

LOVE EACH OTHER



2022 v1.0

LEO PUMP GROUP CO.,LTD.
LEO GROUP PUMP(ZHEJIANG) CO.,LTD.

📍 No.1, 3rd Street, East Industry Center, Wenling, Zhejiang, China, 317511
🌐 www.leogroup.cn ✉ export@leogroup.cn
☎ +86-576-8998 6556 📞 +86-576-8998 9898



Exploring more by scanning!

LEO PUMP GROUP CO.,LTD.
LEO GROUP PUMP(ZHEJIANG) CO.,LTD.

LEO reserves all the right of products modification without prior notification.

LEO PUMP, founded in 1995, is a leading professional pump & system solution provider, engaged in R&D, manufacture, sales and service of all series pumps and systems. Our products are widely used in water conservancy & water resources, power plants, petrochemical industry, mining&metallurgical industry, civilian water applications, garden machinery and solar pump& system.

With more than 27 years' profession and experience, LEO has become one of the world's famous pump brands. We've set up many production and sales subsidiaries in key regional markets, such as USA, Hungary, Thailand, Indonesia, Dubai, Bangladesh, Russia, UK and Malaysia. Our innovations have brought changes to more than 145 countries and regions, served over 500 million end-users.

We keep adhering to philosophy of "run business with virtue,pursue success with perfection, win victory with efficiency, go forward with right actions" and focus on developing safe and high-efficiency pump and system, being a sustainable development industry leader. Going forward we will continue our consistent creativity and development ability in each pump for human's health!

1995

Establish Wenling Xinke Pump Research Institute.

2007

Got listed in Shenzhen Stock Exchange.

2014&2015

Set up LEO Dubai.
Established integrated digital Media group.

2021

Set up LEO Malaysia.
Enter into the global pump project industry.

2001

Exported to EU.
Set up Taizhou LEO Electric Co., Ltd

2012

Complete the layout of industrial pump.
Set up LEO Hungary.

2016&2017

Set up LEO Indonesia and LEO Thailand.
Set up LEO Bangladesh

LEO WORLD

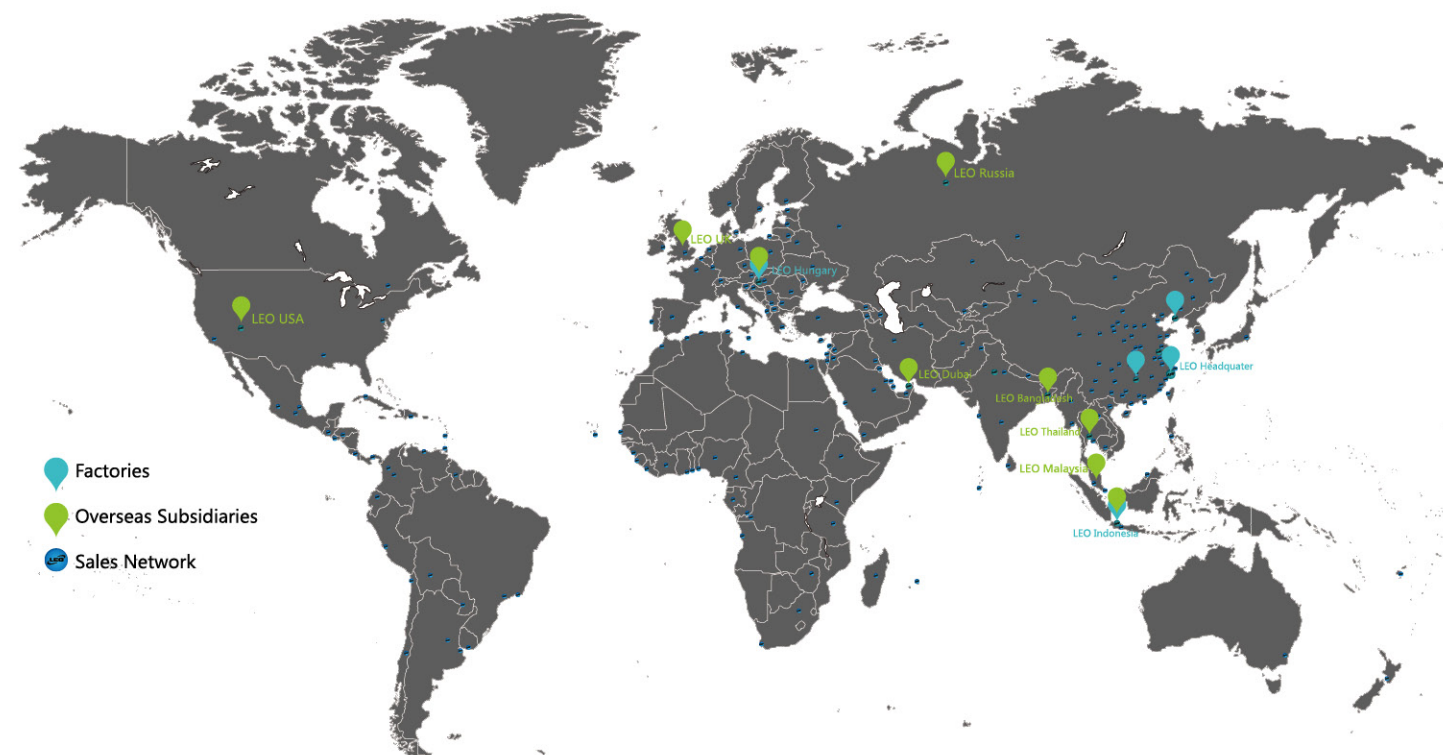

Globally we have 5 production plants and relevant professional sales and technical teams with over 500 technicians to support global sales and service. We also set up several sales and production subsidiaries in key regional markets such as USA, Hungary, Thailand, Indonesia, Dubai, Bangladesh, Russia, UK and Malaysia with global employees over 6,000.

With the past 27 years' devoting experience and extraordinary comprehensive strength, LEO has obtained over 700 patents and become a leading pump company in China and we will keep focus on the development of safe and high-efficient pump&system, being a sustainable enterprise in the industry!

LEO IN NUMBERS

5

Production Bases

145

Countries

1,200⁺

Domestic authorized agency

9

Overseas subsidiaries

500⁺

Million end-users served

15,000⁺

Global sales outlets





1.1kW~7.5kW

9.2kW~22kW

Application

- Water supply: filtration and transfer at waterworks, regional water supply and pressure boosting in main pipe
- Industrial pressure boosting: Water system, cleaning system
- Industrial water supply: boiler feeding, cooling system, air conditioning, transportation of light acid and alkali liquid
- Water treatment: distillation systems, separators, swimming pools
- Agricultural irrigation, petrochemical industry, medicine and sanitation, etc.

Operating Conditions

- Thin, clean, non-flammable and explosive, not containing the liquid with solid particles and fibers
- Liquid temperature: -15°C - +80°C
- Flow range: 0.7 - 132 m³/h
- Head range: 9 - 58 m
- Ambient temperature range: -15°C - +40°C
- Max. operating pressure: 10 bar
- Altitude: up to 1000 m
- Liquid PH valve: 3 - 9
- Max. ambient temperature: +40°C

Motor

- IE2 Motor (IE3 motor available on request for power ≥ 9.2kW)
- Totally enclosed & fan-cooled
- Protection class: IP55
- Insulation class: F

Identification Codes

XZB 65- 50- 160 / 40

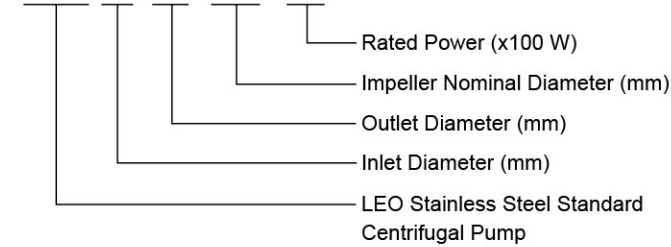

Accessories on Request



AISI304 Threaded flange



Flange gasket

Materials Table

1.1kW ~ 7.5kW

| No. | Part | Material |
|-----|-----------|----------|
| 1 | Pump body | AISI 316 |
| 2 | Impeller | AISI 316 |
| 3 | O-ring | NBR |
| 4 | Support | HT200 |
| 5 | Oil seal | |
| 6 | Bearing | |
| 7 | Rotor | |
| 8 | Stand | HT200 |
| 9 | Bearing | |
| 10 | Oil seal | |

| No. | Part | Material |
|-----|-----------------|----------|
| 11 | Fan | PP |
| 12 | Fan cover | PP-GF15 |
| 13 | Rear cover | ZL102 |
| 14 | Nameplate | AISI 316 |
| 15 | Stator | |
| 16 | Terminal cover | ZL102 |
| 17 | Terminal board | |
| 18 | Cable holder | |
| 19 | Support cover | AISI 316 |
| 20 | Mechanical seal | |

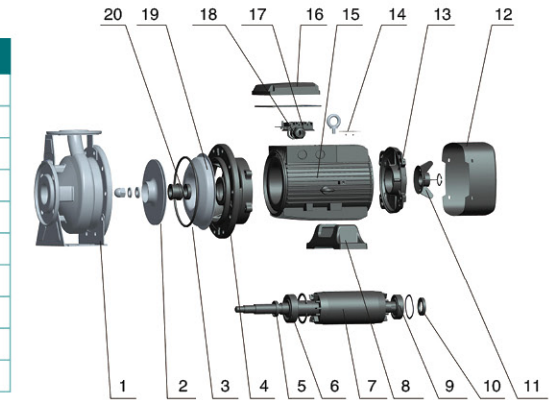

9.2kW ~ 22kW

| No. | Part | Material |
|-----|-----------------|-----------------|
| 1 | Pump body | AISI 316 |
| 2 | Impeller | AISI 316 |
| 3 | O-ring | NBR |
| 4 | Support cover | AISI 316 |
| 5 | Support | HT200 |
| 6 | Motor | |
| 7 | Rotor | AISI 316 / CI45 |
| 8 | Nameplate | AISI 316 |
| 9 | Guard plate | AISI 316 |
| 10 | Mechanical seal | |

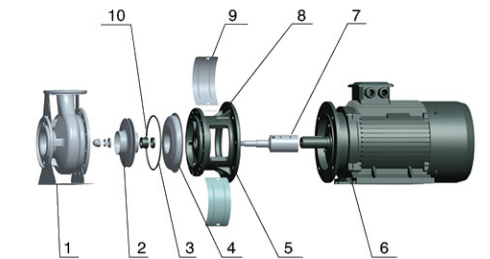

Ambient Temperature

Max. Ambient temperature: +40°C. Ambient temperature above 40°C, or installation at altitude of more than 1000 m above sea level, require the use of an oversize motor. Because of low air density and poor cooling effects, the motor output power P₂ will be decreased. See the picture.

For example, when the pump is installed at altitude of more than 3500 m above sea level, P₂ will be decrease to 88%. When the ambient temperature is 70°C, P₂ will be decreased to 78%.

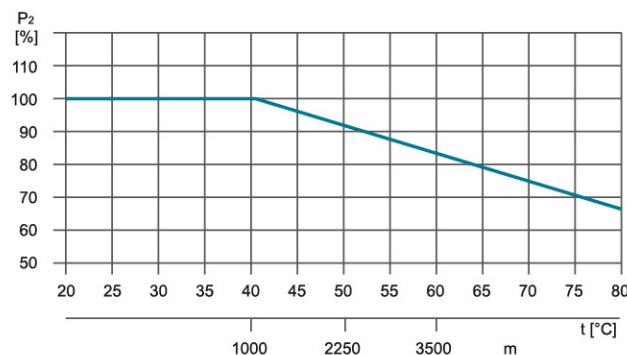

How to Read the Curve Charts

The thin curves indicate the duty range where long-time operating is not allowed

The bold curves indicate the duty range where long-time operating is permitted for best efficiency

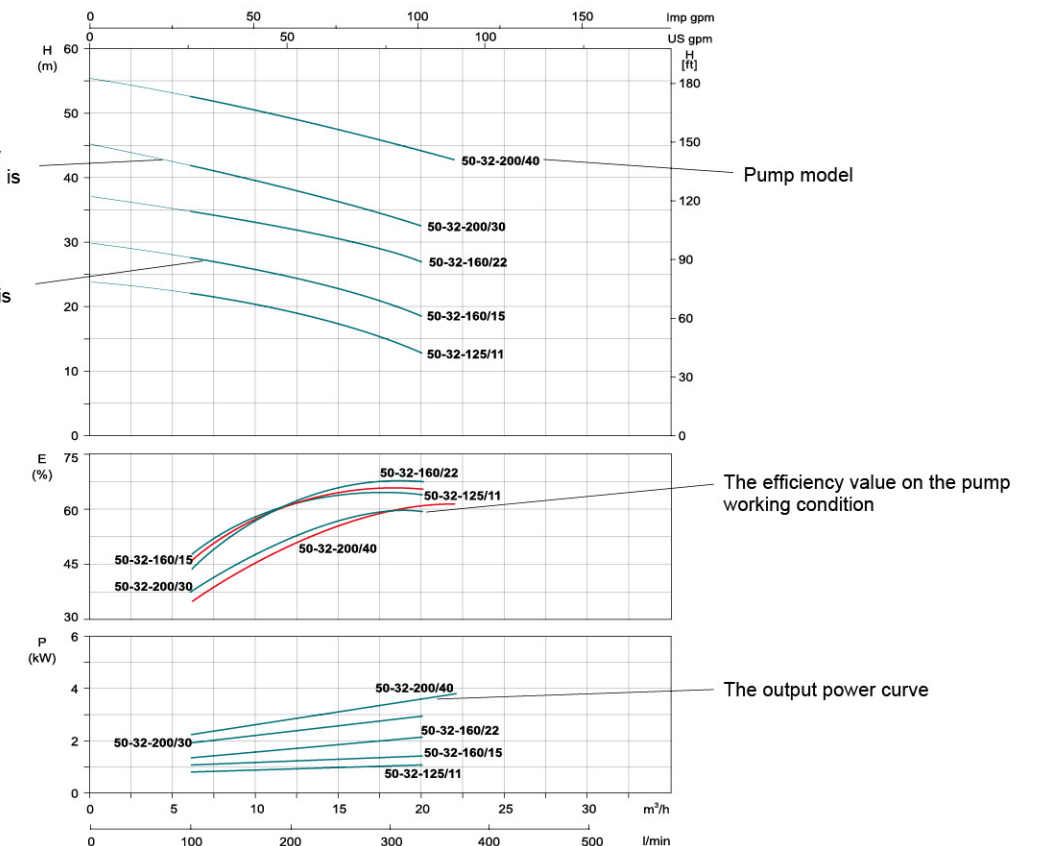

Technical Data

| Model | | Power | | Q(m³/h) | 0 | 6 | 9 | 12 | 18 | 20 | 22 | 24 | 27 | 30 | 36 | 42 | 48 | 60 | 72 | 90 | 108 | 114 | 120 | 126 | 132 | | |
|--------------------|------------------|-------|-----|----------|------|------|------|------|------|-----|------|------|------|------|------|------|------|------|------|------|------|------|------|------|------|----|---|
| GB5662 Standard | EN733 Standard | kW | HP | Q(l/min) | 0 | 100 | 150 | 200 | 300 | 333 | 360 | 400 | 450 | 500 | 600 | 700 | 800 | 1000 | 1200 | 1500 | 1800 | 1900 | 2000 | 2100 | 2200 | | |
| XZB50-32-125/11 | | 1.1 | 1.5 | | 24 | 21.5 | 20.5 | 19.5 | 16 | 13 | - | - | - | - | - | - | - | - | - | - | - | - | - | - | - | | |
| XZB50-32-160/15 | | 1.5 | 2 | | 29.5 | 27 | 26 | 25 | 21 | 18 | - | - | - | - | - | - | - | - | - | - | - | - | - | - | - | | |
| XZB50-32-160/22 | | 2.2 | 3 | | 37 | 33.5 | 32.5 | 32 | 28.5 | 27 | - | - | - | - | - | - | - | - | - | - | - | - | - | - | - | | |
| XZB50-32-200/30 | | 3 | 4 | | 45 | 41 | 40 | 38 | 34 | 32 | - | - | - | - | - | - | - | - | - | - | - | - | - | - | - | | |
| XZB50-32-200/40 | | 4 | 5.5 | | 55 | 51 | 50 | 49 | 46 | 45 | 43 | - | - | - | - | - | - | - | - | - | - | - | - | - | - | | |
| XZB65-50-125/15 | XZB65-40-125/15 | 1.5 | 2 | H (m) | 20 | - | - | 19 | 18 | 17 | 16.5 | 15 | 14 | 12.5 | 10 | - | - | - | - | - | - | - | - | - | - | | |
| XZB65-50-125/22 | XZB65-40-125/22 | 2.2 | 3 | | 26 | - | - | 23.5 | 22.5 | 22 | 21.5 | 21 | 20.5 | 19.5 | 16.5 | - | - | - | - | - | - | - | - | - | - | - | |
| XZB65-50-160/30 | XZB65-40-160/30 | 3 | 4 | | 31 | - | - | 29 | 27.5 | 27 | 26.5 | 25.5 | 25 | 24 | 22 | 19 | - | - | - | - | - | - | - | - | - | - | |
| XZB65-50-160/40 | XZB65-40-160/40 | 4 | 5.5 | | 39 | - | - | 35.5 | 34.5 | 34 | 33.5 | 32.5 | 32 | 31 | 29 | 26 | - | - | - | - | - | - | - | - | - | - | - |
| XZB65-40-200/55 | | 5.5 | 7.5 | | 47 | - | - | 43 | 42.5 | 42 | 41.5 | 41 | 40.5 | 39 | 37 | 33 | - | - | - | - | - | - | - | - | - | - | - |
| XZB65-40-200/75 | | 7.5 | 10 | | 57 | - | - | 53 | 52.5 | 52 | 51 | 50 | 49 | 48 | 46.5 | 44.5 | - | - | - | - | - | - | - | - | - | - | - |
| XZB80-65-125/30 | XZB65-50-125/30 | 3 | 4 | | 22.5 | - | - | - | - | - | - | 20 | 19.5 | 19 | 18.5 | 17.5 | 16 | 13 | 9 | - | - | - | - | - | - | - | - |
| XZB80-65-125/40 | XZB65-50-125/40 | 4 | 5.5 | | 25.5 | - | - | - | - | - | - | 23 | 22.5 | 22 | 21.5 | 20.5 | 20 | 17 | 13.5 | - | - | - | - | - | - | - | - |
| XZB80-65-160/55 | XZB65-50-160/55 | 5.5 | 7.5 | | 33 | - | - | - | - | - | - | 29.5 | 29 | 28.5 | 28 | 27 | 26 | 24 | 20 | - | - | - | - | - | - | - | - |
| XZB80-65-160/75 | XZB65-50-160/75 | 7.5 | 10 | | 39 | - | - | - | - | - | - | 36 | 35 | 34.5 | 34 | 33.5 | 32.5 | 29 | 24 | - | - | - | - | - | - | - | - |
| *XZB80-50-200/92 | XZB65-50-200/92 | 11 | 15 | | 53 | - | - | - | - | - | - | - | - | - | 48 | 47.5 | 46.5 | 44.5 | 39.5 | 34 | - | - | - | - | - | - | - |
| *XZB80-50-200/110 | XZB65-50-200/110 | 11 | 15 | | 57.5 | - | - | - | - | - | - | - | - | - | 53 | 51 | 50.5 | 50 | 47 | 41 | - | - | - | - | - | - | - |
| XZB100-80-125/40 | | 4 | 5.5 | 20 | - | - | - | - | - | - | - | - | - | 17.5 | 16.5 | 15.5 | 14 | 12 | 7 | - | - | - | - | - | - | - | |
| XZB100-80-125/55 | | 5.5 | 7.5 | 23 | - | - | - | - | - | - | - | - | - | 21.5 | 20.5 | 20 | 18 | 16 | 12 | 7.5 | - | - | - | - | - | - | |
| XZB100-80-125/75 | XZB80-65-125/75 | 7.5 | 10 | 29 | - | - | - | - | - | - | - | - | - | 27.5 | 26.5 | 25.5 | 23.5 | 21.5 | 17.5 | 13 | 12 | - | - | - | - | - | |
| *XZB100-80-160/92 | XZB80-65-160/92 | 11 | 15 | 33 | - | - | - | - | - | - | - | - | - | - | 31 | 30 | 28 | 26 | 23 | - | - | - | - | - | - | - | |
| *XZB100-80-160/110 | XZB80-65-160/110 | 11 | 15 | 38.5 | - | - | - | - | - | - | - | - | - | - | 36 | 35 | 33 | 31 | 28 | - | - | - | - | - | - | - | |
| *XZB100-65-200/150 | | 15 | 20 | 47 | - | - | - | - | - | - | - | - | - | - | 44 | 43 | 41 | 39 | 36 | 32 | 30 | 28 | 26 | 23 | 23 | 23 | |
| *XZB100-65-200/185 | | 18.5 | 25 | 53 | - | - | - | - | - | - | - | - | - | - | 51 | 50 | 49 | 48 | 45 | 41 | 39 | 37 | 35 | 33 | 33 | 33 | |
| *XZB100-65-200/220 | | 22 | 30 | 58 | - | - | - | - | - | - | - | - | - | - | 57 | 56 | 55 | 54 | 51 | 47 | 45.5 | 44 | 42 | 40 | 40 | 40 | |

* =IE3 motor optional on request.

Characteristic Curves

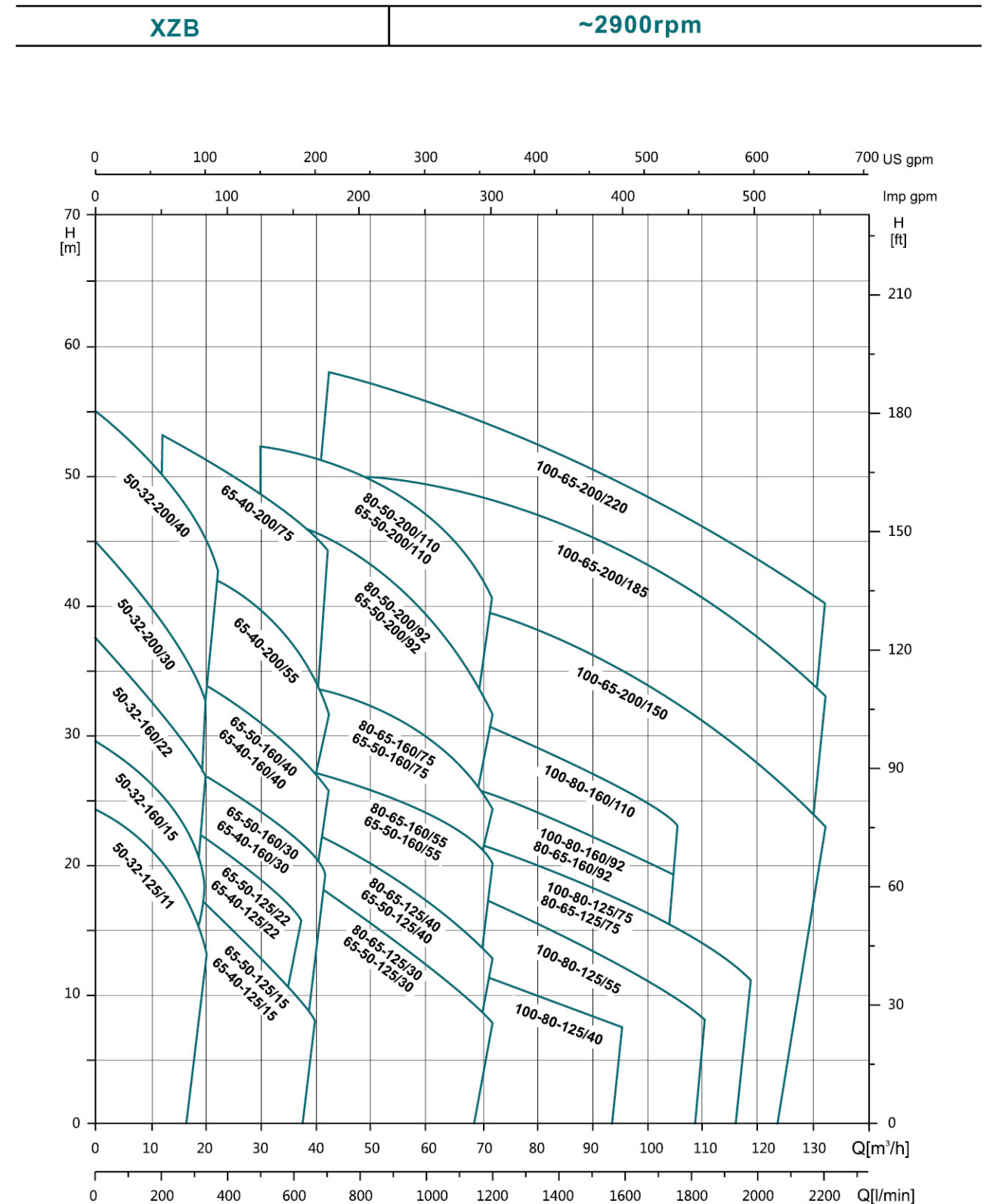

Hydraulic Performance Curves

Hydraulic Performance Curves

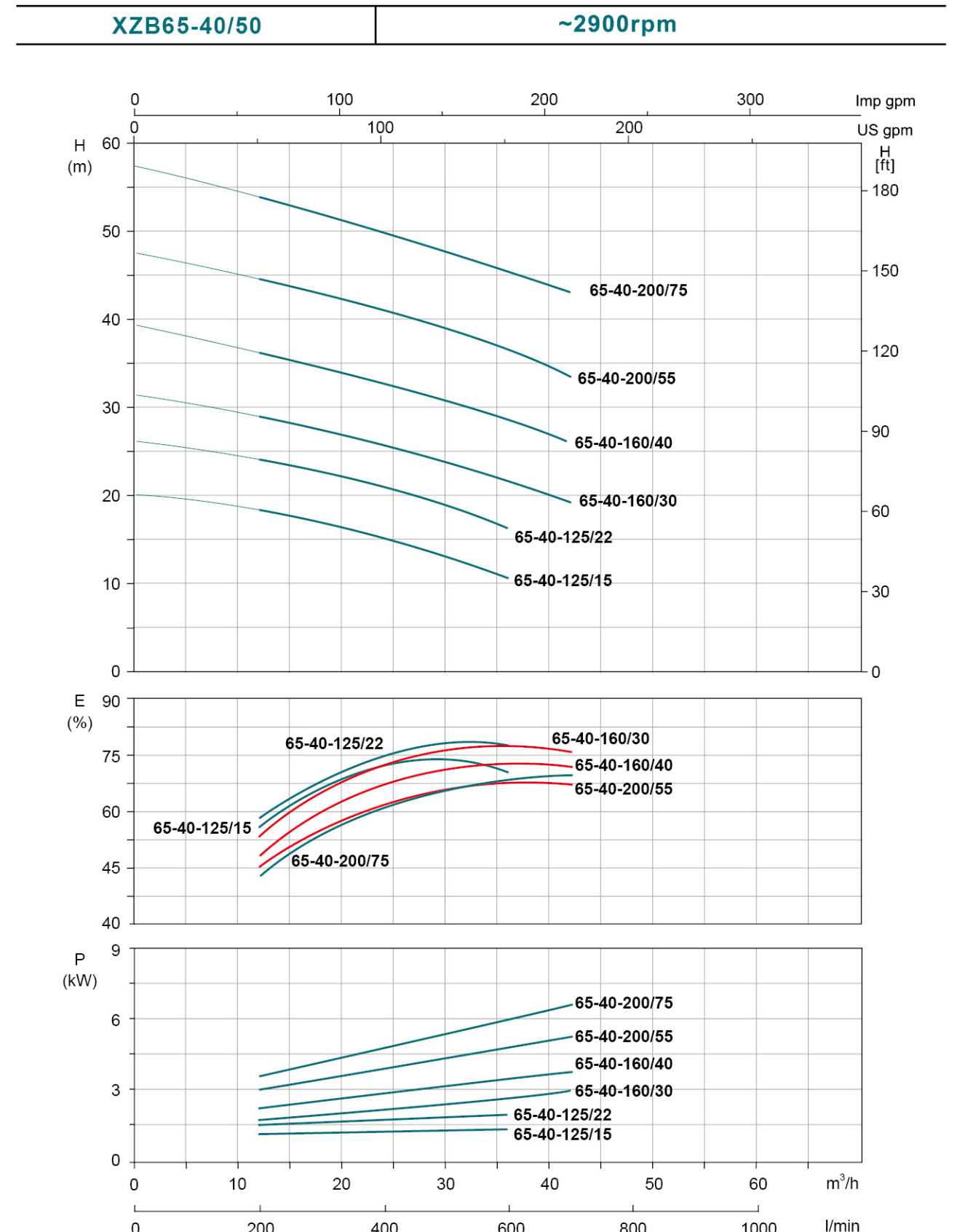
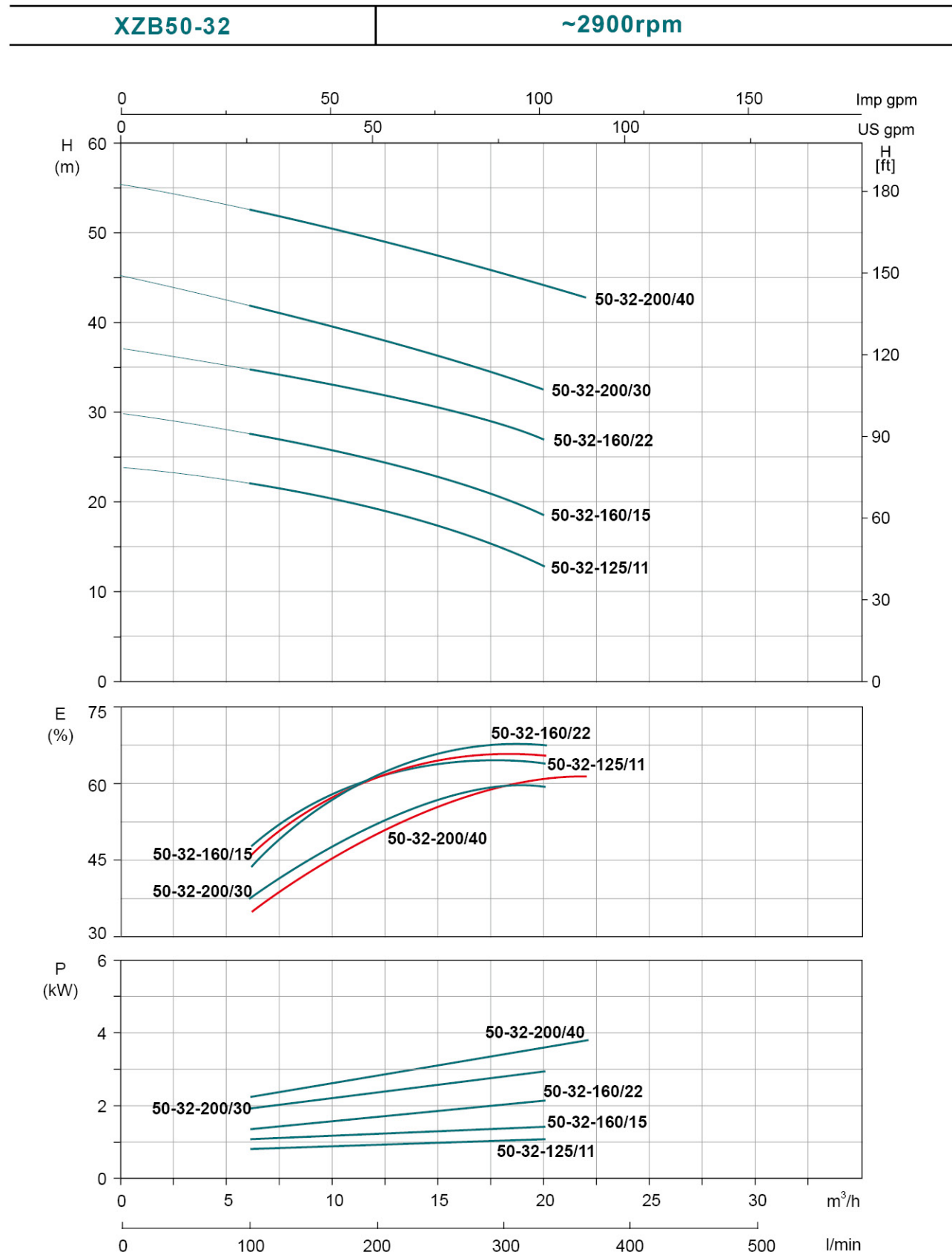

Hydraulic Performance Curves

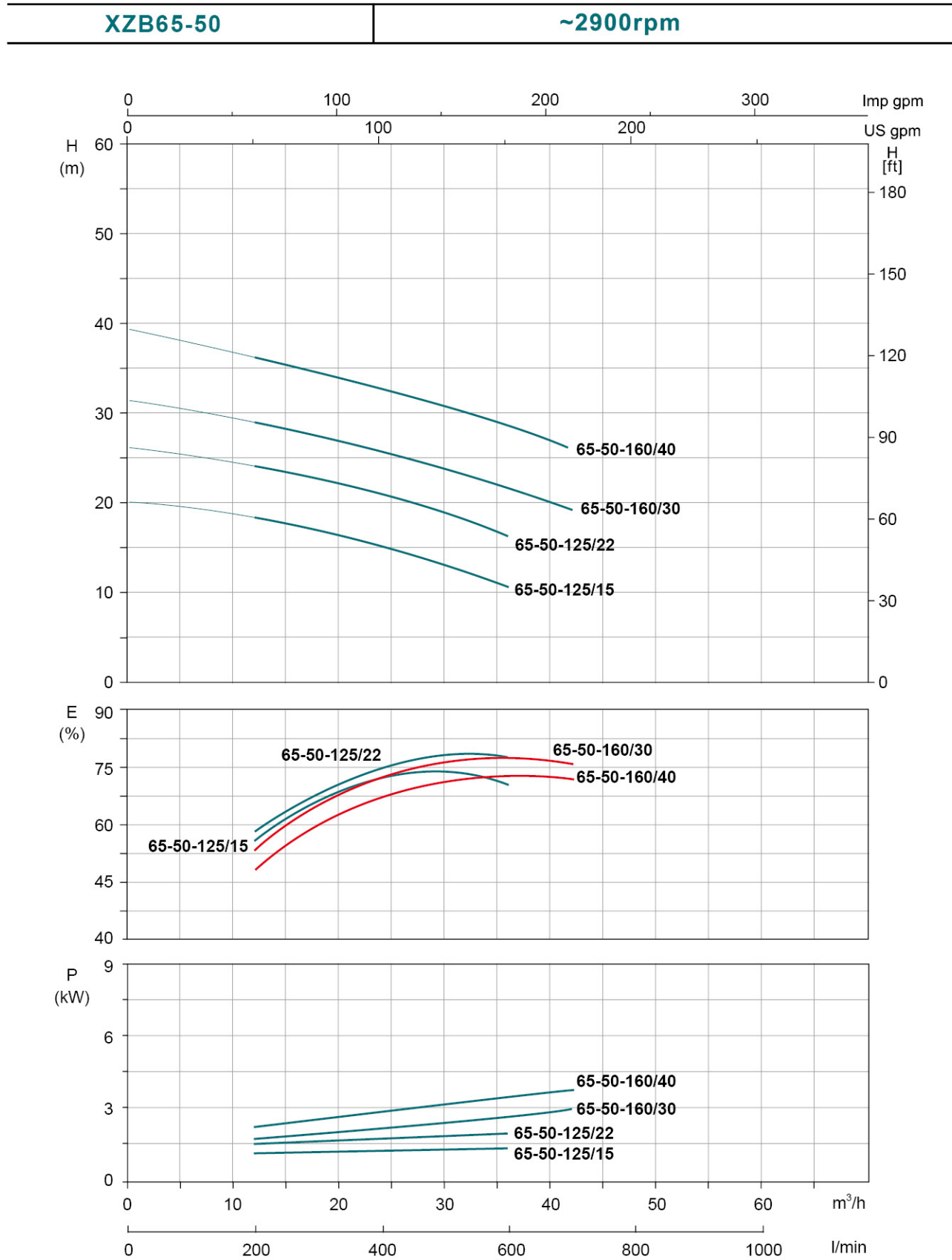

Hydraulic Performance Curves

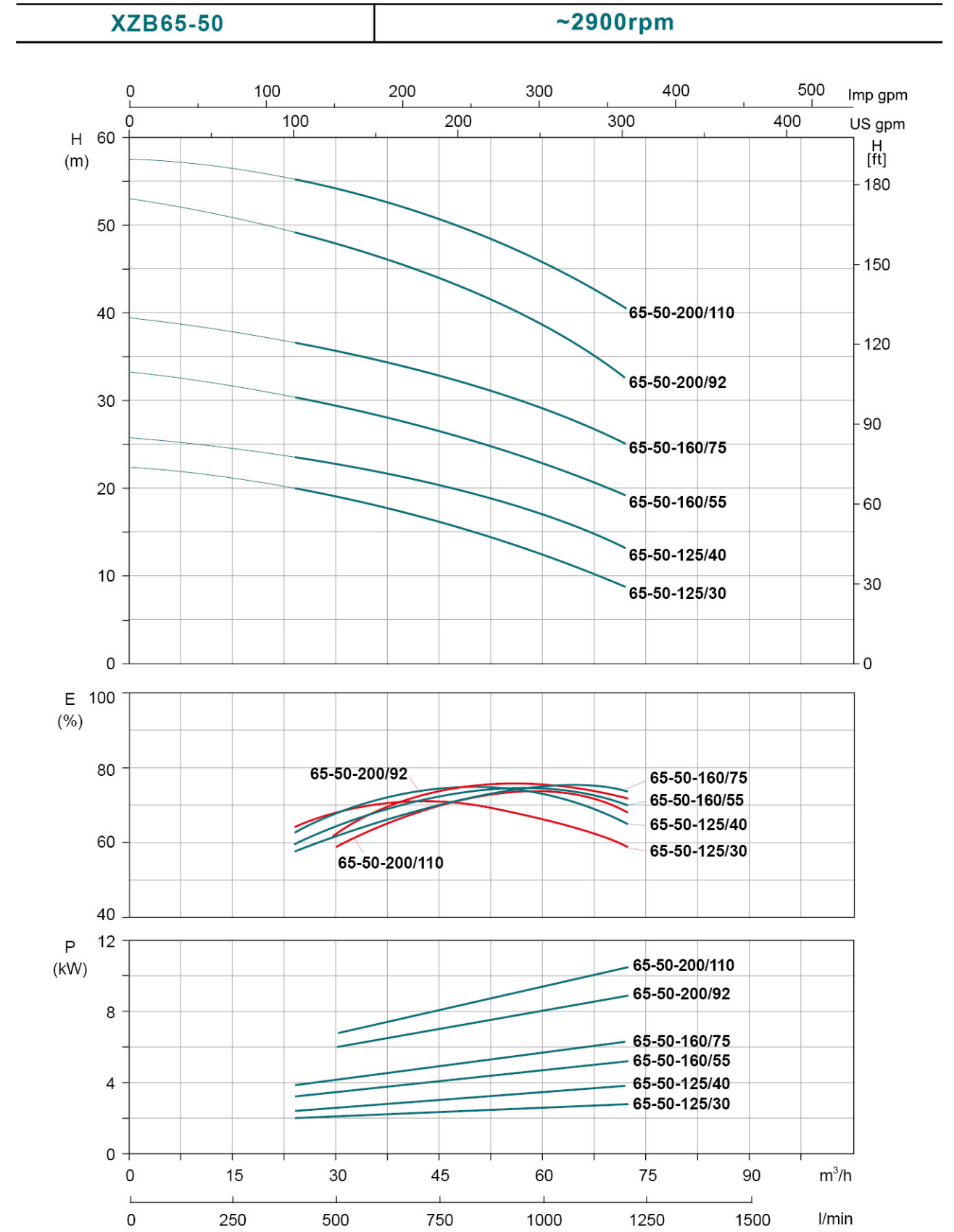

Hydraulic Performance Curves

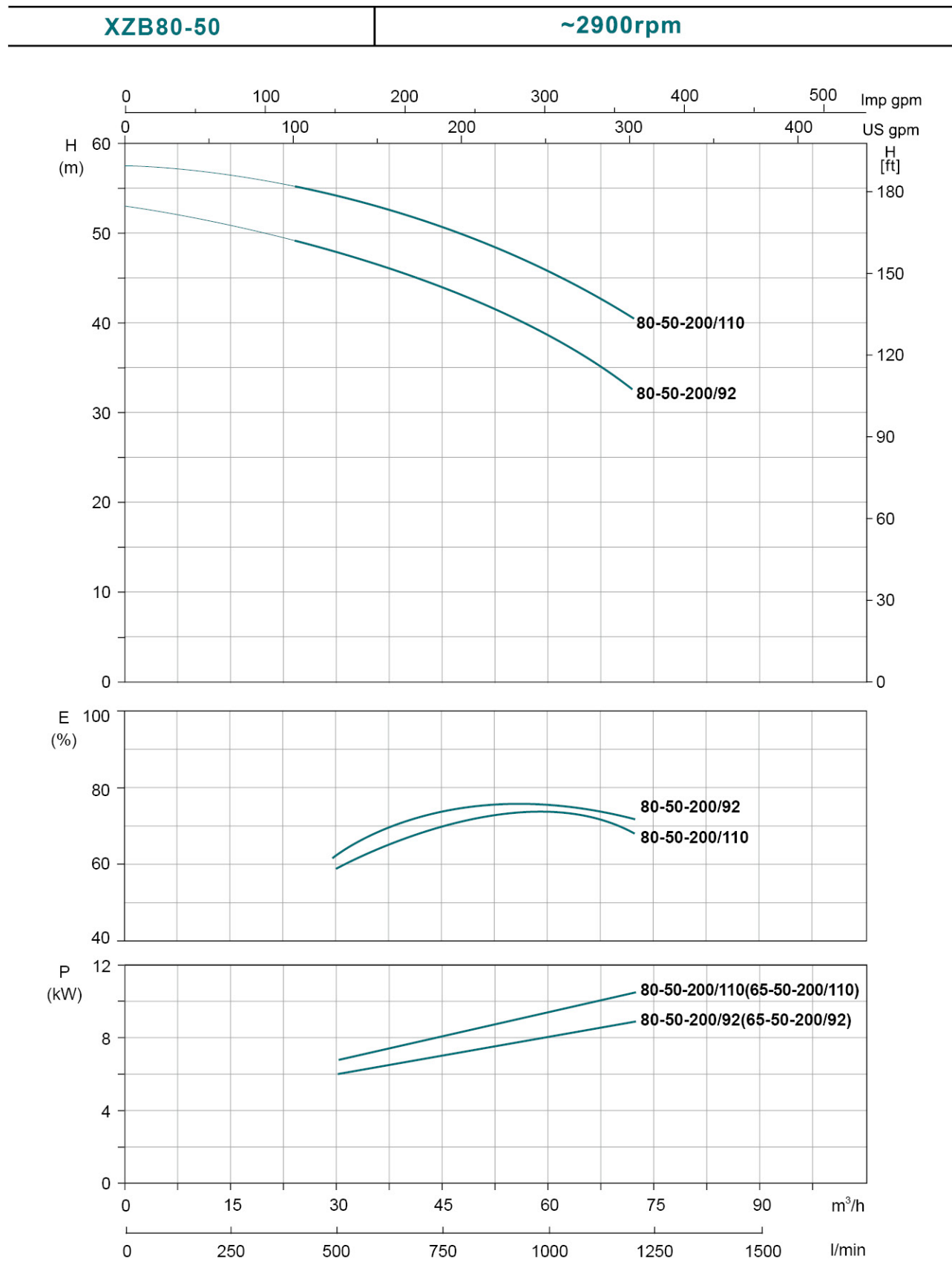

Hydraulic Performance Curves

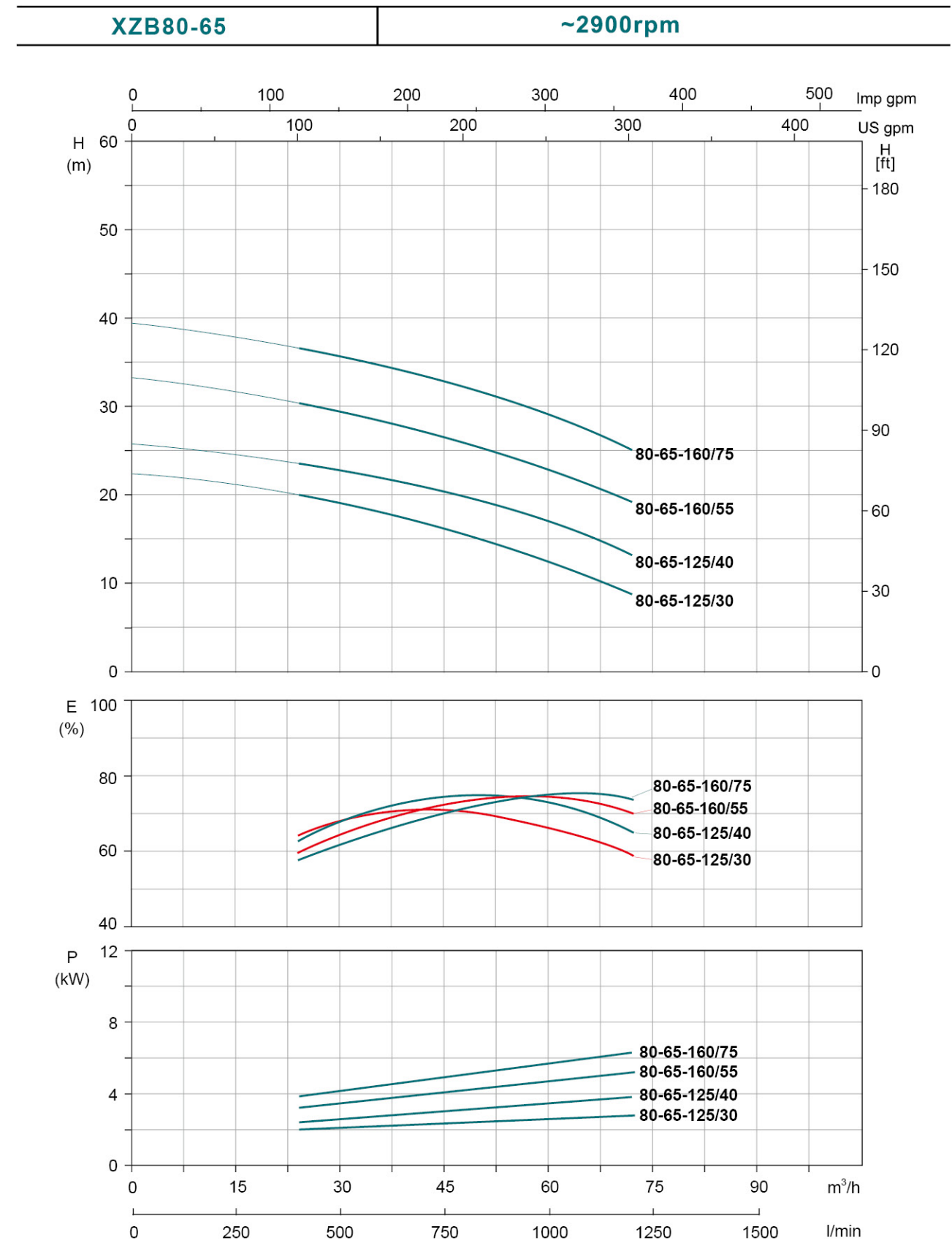

Hydraulic Performance Curves

Hydraulic Performance Curves

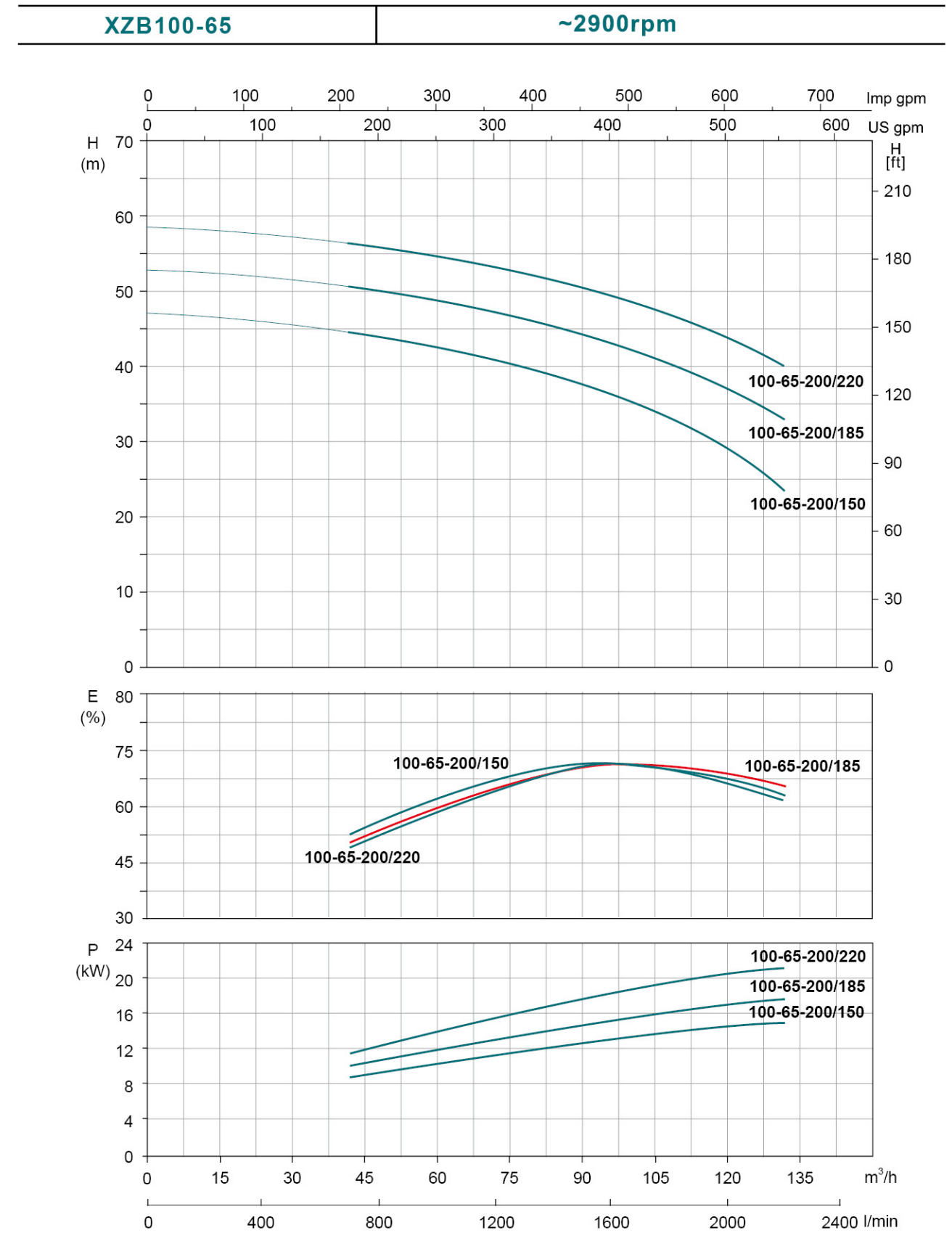
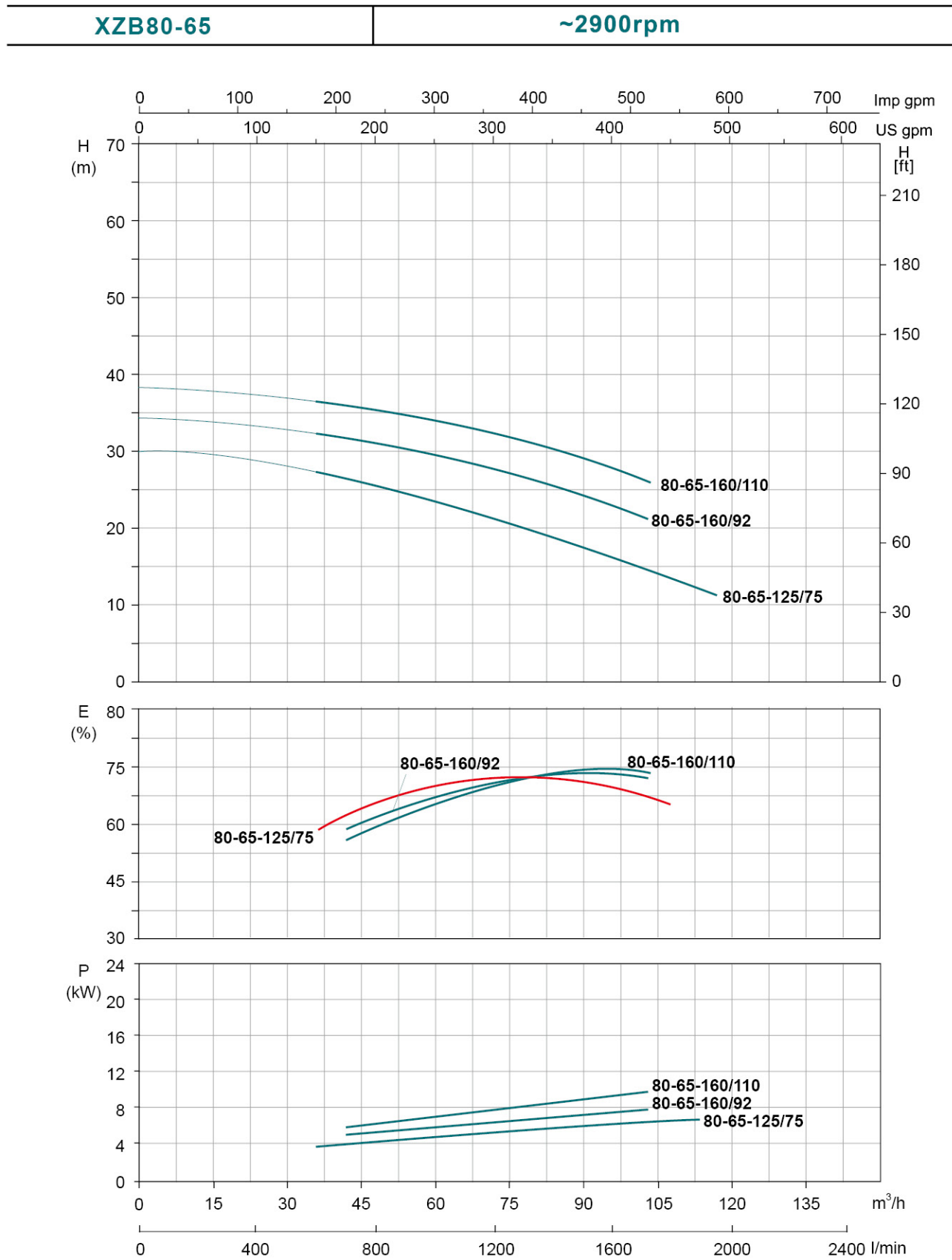

Hydraulic Performance Curves

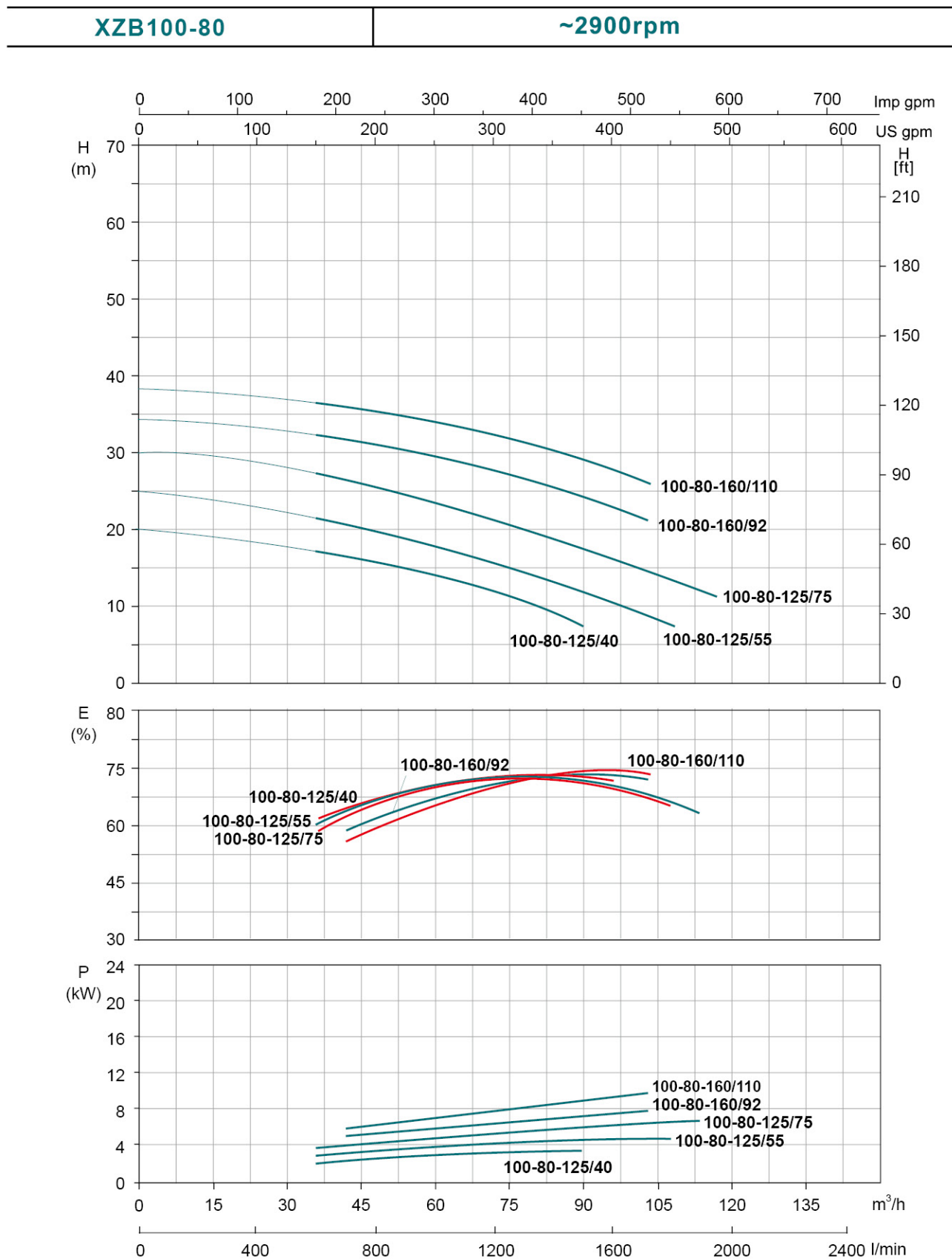

Installation Sketch

For model ≤ 7.5kW

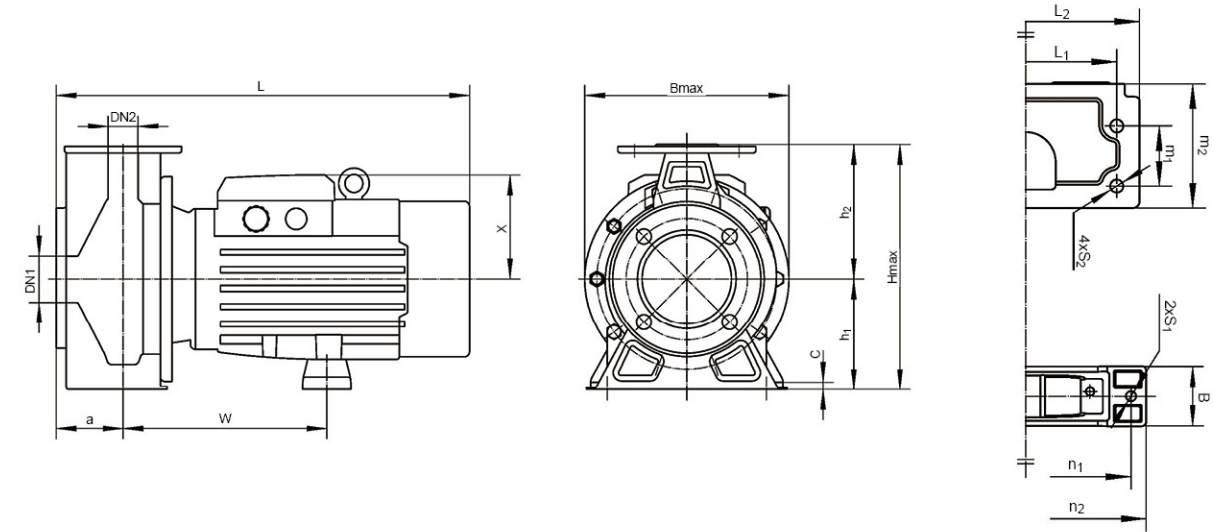

| Model | DN1 | DN2 | a | W | L | L1 | L2 | m1 | m2 | n1 | n2 | h1 | h2 | 2-S1 | 4-S2 | B | C | X | Bmax | Hmax |
|------------------|-----|-----|-----|-----|-----|-----|-----|----|-----|-----|-----|-----|-----|-------|-------|----|----|-----|------|------|
| XZB50-32-125/11 | 50 | 32 | 80 | 205 | 475 | 140 | 190 | 70 | 122 | 205 | 240 | 112 | 140 | 2-Ø12 | 4-Ø15 | 65 | 12 | 127 | 240 | 250 |
| XZB50-32-160/15 | 50 | 32 | 80 | 207 | 477 | 190 | 240 | 70 | 122 | 205 | 240 | 132 | 160 | 2-Ø12 | 4-Ø15 | 65 | 12 | 127 | 244 | 292 |
| XZB50-32-160/22 | 50 | 32 | 80 | 207 | 477 | 190 | 240 | 70 | 122 | 205 | 240 | 132 | 160 | 2-Ø12 | 4-Ø15 | 65 | 12 | 127 | 244 | 292 |
| XZB50-32-200/30 | 50 | 32 | 80 | 244 | 492 | 190 | 240 | 70 | 124 | 225 | 260 | 160 | 180 | 2-Ø12 | 4-Ø15 | 75 | 15 | 124 | 295 | 340 |
| XZB50-32-200/40 | 50 | 32 | 80 | 244 | 492 | 190 | 240 | 70 | 124 | 225 | 260 | 160 | 180 | 2-Ø12 | 4-Ø15 | 75 | 15 | 124 | 295 | 340 |
| XZB65-50-125/15 | 65 | 50 | 80 | 205 | 475 | 160 | 210 | 70 | 121 | 205 | 240 | 112 | 140 | 2-Ø12 | 4-Ø15 | 65 | 12 | 127 | 240 | 252 |
| XZB65-50-125/22 | 65 | 50 | 80 | 205 | 475 | 160 | 210 | 70 | 121 | 205 | 240 | 112 | 140 | 2-Ø12 | 4-Ø15 | 65 | 12 | 127 | 240 | 252 |
| XZB65-50-160/30 | 65 | 50 | 80 | 244 | 492 | 190 | 240 | 70 | 123 | 225 | 260 | 132 | 160 | 2-Ø12 | 4-Ø15 | 75 | 15 | 124 | 260 | 292 |
| XZB65-50-160/40 | 65 | 50 | 80 | 244 | 492 | 190 | 240 | 70 | 123 | 225 | 260 | 132 | 160 | 2-Ø12 | 4-Ø15 | 75 | 15 | 124 | 260 | 292 |
| XZB65-40-200/55 | 65 | 40 | 40 | 246 | 563 | 212 | 265 | 70 | 146 | 245 | 280 | 160 | 180 | 2-Ø12 | 4-Ø15 | 70 | 15 | 142 | 295 | 340 |
| XZB65-40-200/75 | 65 | 40 | 40 | 246 | 563 | 212 | 265 | 70 | 146 | 245 | 280 | 160 | 180 | 2-Ø12 | 4-Ø15 | 70 | 15 | 142 | 295 | 340 |
| XZB80-65-125/30 | 80 | 65 | 65 | 254 | 522 | 190 | 240 | 70 | 158 | 225 | 260 | 132 | 160 | 2-Ø12 | 4-Ø15 | 75 | 15 | 124 | 260 | 292 |
| XZB80-65-125/40 | 80 | 65 | 65 | 254 | 522 | 190 | 240 | 70 | 158 | 225 | 260 | 132 | 160 | 2-Ø12 | 4-Ø15 | 75 | 15 | 124 | 260 | 292 |
| XZB80-65-160/55 | 80 | 65 | 65 | 256 | 573 | 212 | 265 | 70 | 150 | 245 | 280 | 160 | 180 | 2-Ø12 | 4-Ø15 | 70 | 15 | 142 | 280 | 340 |
| XZB80-65-160/75 | 80 | 65 | 65 | 256 | 573 | 212 | 265 | 70 | 150 | 245 | 280 | 160 | 180 | 2-Ø12 | 4-Ø15 | 70 | 15 | 142 | 280 | 340 |
| XZB100-80-125/40 | 100 | 80 | 80 | 256 | 524 | 212 | 280 | 95 | 155 | 225 | 260 | 160 | 180 | 2-Ø12 | 4-Ø15 | 75 | 15 | 124 | 280 | 340 |
| XZB100-80-125/55 | 100 | 80 | 80 | 258 | 575 | 212 | 280 | 95 | 155 | 245 | 280 | 160 | 180 | 2-Ø12 | 4-Ø15 | 70 | 15 | 142 | 280 | 340 |
| XZB100-80-125/75 | 100 | 80 | 80 | 258 | 575 | 212 | 280 | 95 | 155 | 245 | 280 | 160 | 180 | 2-Ø12 | 4-Ø15 | 70 | 15 | 142 | 280 | 340 |
| XZB65-40-125/15 | 65 | 40 | 80 | 205 | 475 | 160 | 210 | 70 | 121 | 205 | 240 | 112 | 140 | 2-Ø12 | 4-Ø15 | 65 | 12 | 127 | 240 | 252 |
| XZB65-40-125/22 | 65 | 40 | 80 | 205 | 475 | 160 | 210 | 70 | 121 | 205 | 240 | 112 | 140 | 2-Ø12 | 4-Ø15 | 65 | 12 | 127 | 240 | 252 |
| XZB65-40-160/30 | 65 | 40 | 80 | 244 | 492 | 190 | 240 | 70 | 123 | 225 | 260 | 132 | 160 | 2-Ø12 | 4-Ø15 | 75 | 15 | 124 | 260 | 292 |
| XZB65-40-160/40 | 65 | 40 | 80 | 244 | 492 | 190 | 240 | 70 | 123 | 225 | 260 | 132 | 160 | 2-Ø12 | 4-Ø15 | 75 | 15 | 124 | 260 | 292 |
| XZB65-50-125/30 | 65 | 50 | 100 | 254 | 522 | 190 | 240 | 70 | 158 | 225 | 260 | 132 | 160 | 2-Ø12 | 4-Ø15 | 75 | 15 | 124 | 260 | 292 |
| XZB65-50-125/40 | 65 | 50 | 100 | 254 | 522 | 190 | 240 | 70 | 158 | 225 | 260 | 132 | 160 | 2-Ø12 | 4-Ø15 | 75 | 15 | 124 | 260 | 292 |
| XZB65-50-160/55 | 65 | 50 | 100 | 256 | 573 | 212 | 265 | 70 | 150 | 245 | 280 | 160 | 180 | 2-Ø12 | 4-Ø15 | 70 | 15 | 142 | 280 | 340 |
| XZB65-50-160/75 | 65 | 50 | 100 | 256 | 573 | 212 | 265 | 70 | 150 | 245 | 280 | 160 | 180 | 2-Ø12 | 4-Ø15 | 70 | 15 | 142 | 280 | 340 |
| XZB80-65-125/75 | 80 | 65 | 100 | 258 | 575 | 212 | 280 | 95 | 155 | 245 | 280 | 160 | 180 | 2-Ø12 | 4-Ø15 | 70 | 15 | 142 | 280 | 340 |

